



PROCESSING INSTRUCTIONS

FOR ADHESIVE VENEER & SELF-ADHESIVE FURNITURE LINOLEUM



Different bonding methods can be used depending on the nature of the substrate. In any case, it is important that the surface is free of any dust, dirt, grease, wax and silicone residue and is as smooth as possible. For convex and concave substrates, mechanical fastening is required in the edge area.

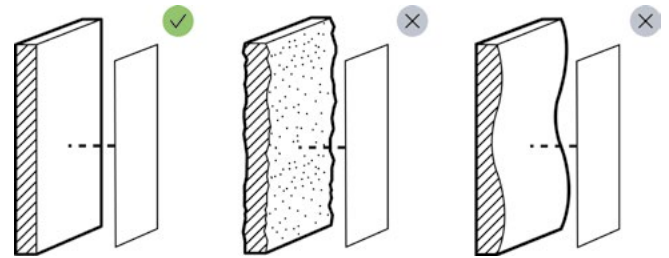

Absorbent substrates

(e.g. chipboard, raw MDF or plasterboard) are not suitable for self-adhesive wall panels

Non-absorbent substrates

(e.g. glass or coated board), on the other hand, are ideal for self-adhesive wall panels



Notes:

- We cannot provide any guarantees for ceiling coverings
- Please test the adhesive strength on the surface in advance
- Only suitable for interiors with low temperature fluctuations
- Deliveries that arrive by parcel must be opened and laid out flat as soon as possible after delivery
- The double-sided adhesive must therefore be pressed down again before further processing (if tension / bubbles appear on the adhesive film, these must be cut with a knife)

